

## THREE AXIS WELDING POSITIONERS

# RotoLift®



Model	Capacity	Plate Rotation <i>EL = Electric</i> <i>OL = Hydraulic</i>	Rotary ground	Ampere	Standard model 400 V 50 HZ	Extra inclination of the plate at 140°	Detached hydraulic control unit (5 m)	Teaching system mod. TCS 400 V 50 HZ	Teaching system mod. TCS 140° version 400 V 50 HZ	Increased plate rotation torque
	kg				See Note 1 (Technical Notes)	POA	See Note 2 (Technical Notes)	POA	POA	POA
RL 1250 OL	1.250	Hydraulic	No							
RL 1250 OL MR			Yes	400						
RL 1250 EL		Electric	No							
RL 1250 EL MR			Yes	400						
RL 2000 OL	2.000	Hydraulic	No							
RL 2000 OL MR			Yes	400						
RL 2000 EL		Electric	No							
RL 2000 EL MR			Yes	400						
RL 3000 OL	3.000	Hydraulic	No							
RL 3000 OL MR			Yes	400						
RL 3000 EL		Electric	No							
RL 3000 EL MR			Yes	400						
RL 4500 EL	4.500	Electric	No							
RL 4500 EL MR			Yes	1500						
RL 6500 EL	6.500	Electric	No							
RL 6500 EL MR			Yes	1500						
RL 8500 EL	8.500	Electric	No							
RL 8500 EL MR			Yes	1500						
RL 11000 EL	11.000	Electric	No							
RL 11000 EL MR			Yes	1500						
RL 13000 EL	13.000	Electric	No							
RL 13000 EL MR			Yes	1500						
RL 18000 EL	18.000	Electric	No							
RL 18000 EL MR			Yes	1500						

## STANDARD EQUIPMENTS

Hydraulic system with hydraulic control unit fixed laterally or posteriorly.

Rotating plate inclination: 95°.

Perforated plates for fixing the workpiece and/or jig.

Electric board and pushbutton panel with its support and connection cable 6 m long.

No. 2 lateral safety barriers. No other mechanical and/or optical barriers are provided.

5 m long power cable.

**Painting: body WHITE RAL 9003 – Plate BLACK RAL 9003 – Protection barriers and carters BLUE RAL 5015**  
*Customized painting on request (surcharges may apply)*

## OPTIONAL



Extra inclination of the plate at 140°



Foot pedal for rotation control



Detached hydraulic control unit



Teaching system mod. TCS

Foot pedal for rotation control

End-stroke sensor for RL 1250 – 2000 – 3000 – 6500 – 8500 – 11000 – 13000 – 18000

Wireless pushbutton panel

Double push-button

Laser Scanner mod. S300 Standard  
(Programming excluded)

Customized perforated plates for fixing the workpiece and/or jig

## SALES CONDITIONS

**Delivery time:** Please always check with us the best delivery for the positioner you need;

**Delivery terms:** EXW Sideros Machinery Srl, Via U. Foscolo 16/18, I Casoni, 29027 Podenzano, Italy (Incoterms 2020).  
DAP/DDP shipments available on request.

**Packing:** price includes sea freight packing (barrier bag, salts) and wooden pallet. Wooden crates on request (with a surcharge).

**On-site installation:** not included but can be quoted separately case by case.

**Payment:** by bank transfer, 50% deposit at order, 50% before shipment.  
*Different payment conditions may be discussed case by case.*

**Warranty:** 12 months on all of our machines starting from the date indicated on the delivery note.

## TECHNICAL NOTES

**Note 1: Hydraulic version:** hydraulic lifting, tilting and rotation;  
**Electric version:** hydraulic lifting and tilting – Electrical rotation with inverter.

**Note 2:** The increased plate rotation torque is not available together with the extra inclination of the plate at 140° for the following models: RL 1250 OL/EL – 2000 OL/EL - 3000 OL.

The pushbutton panel and the foot pedal for rotation control are not included together with the teaching system mod. TCS. However, the positioner is pre-set for both.

The hydraulic control unit can be fixed at the side or at the back. It is also available the version with detached hydraulic control unit (with an extra charge).

The machine must be anchored on the ground. Anchors are not included.

## TECHNICAL DETAILS

Model	Loading Capacity	Max tilting angle	Tilting torque	Max rotation torque	Extra rotation torque	Plate rotation speed	Vertical plate height		Horizontal plate height		Length	Width	Perforated plate dimensions	Weight	Hydraulic control unit power	Rotation motor power
	kg	Deg.	N·m	N·m	N·m	rpm	Amin mm	Amax mm	Bmin mm	Bmax mm	mm	mm	mm	kg	kW	kW
RL 1250	1.250	95°	4.900	490	-	2	540	1.120	700	1.280	1.760	1.630	Ø800	757	2,2	0,33
RL 2000-140°	1.700	140°	6.670	1.570	-	2	550	1.300	850	1.600	1.850	1.660	Ø800	960	2,2	0,33
RL 2000	2.000	95°	7.850	1.570	-	2	550	1.300	650	1.400	1.850	1.660	Ø800	930	2,2	0,33
RL 3000-140°	2.500	140°	11.000	2.350	-	2	740	1.590	870	1.720	2.400	1.825	1100x1100	1.592	4	0,66
RL 3000	3.000	95°	11.750	2.350	7.300	2	740	1.590	720	1.570	2.400	1.825	1100x1100	1.477	4	0,66
RL 4500-140°	4.200	140°	19.800	5.300	-	1.5	830	2.080	1.180	2.430	3.100	2.270	1500x1500	3.300	5,5	1,77
RL 4500	4.500	95°	21.200	5.300	11.000	1.5	830	2.080	880	2.130	3.100	2.270	1500x1500	2.500	5,5	1,77
RL 6500	6.500	95°	31.900	7.500	15.900	1.5	910	2.380	950	2.420	3.600	2.410	1500x1500	3.424	5,5	1,77
RL 8500	8.500	95°	41.700	8.000	20.800	1	980	2.740	1.180	2.840	4.450	2.480	1500x1500	4.360	7,5	1,77
RL 11000	11.000	95°	53.950	10.700	27.000	1	1.100	2.900	1.300	3.200	4.900	2.500	1800x1800	5.100	7,5	3,16
RL 13000	13.000	95°	63.750	15.600	27.000	1	970	2.710	1.260	3.000	4.500	2.500	1800x1800	5.480	11	3,16
RL 18000	18.000	95°	88.000	17.650	To be defined	1	1.070	2.770	1.300	3.000	4900	2800	1800x1800	6.500	To be defined	To be defined

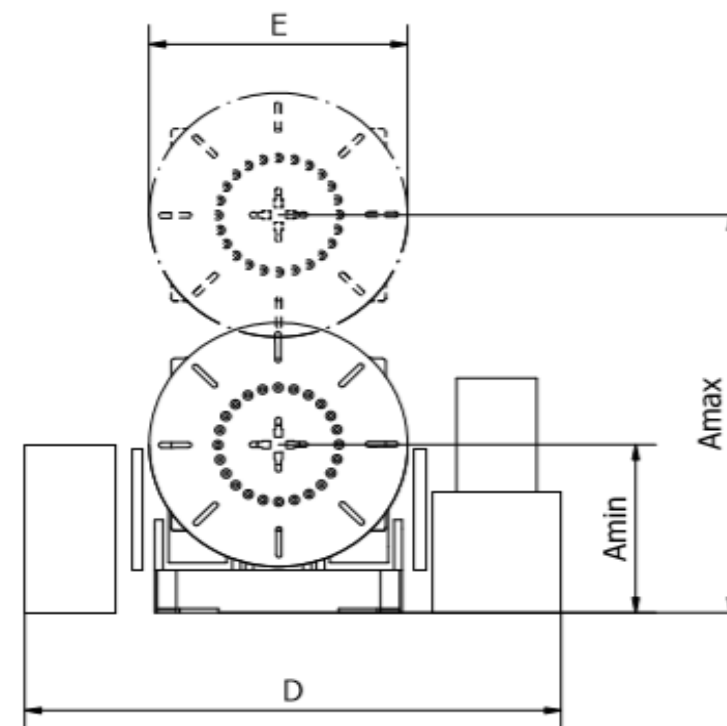
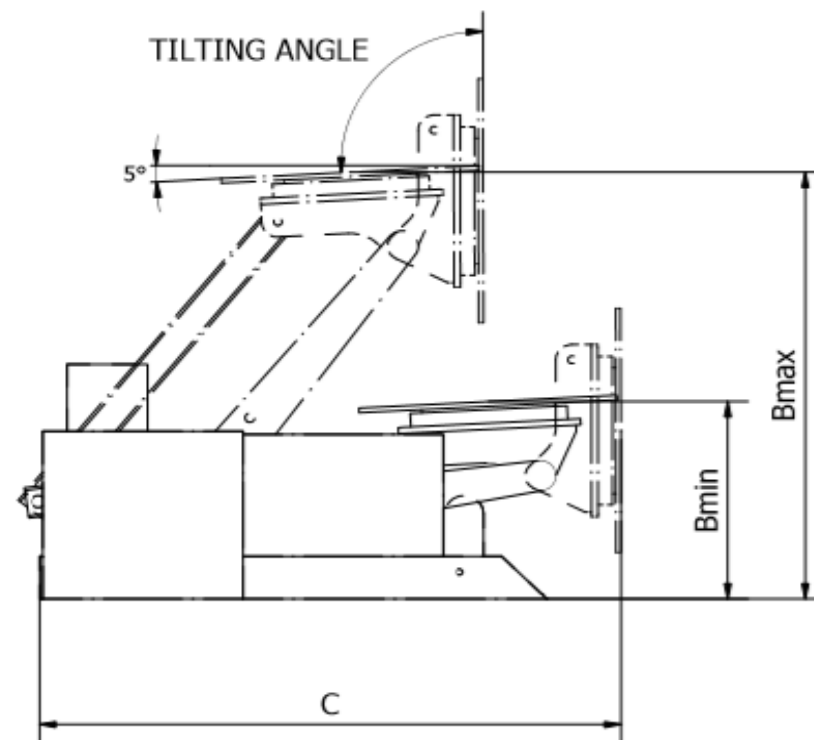

LOADING DIAGRAM RL 1250

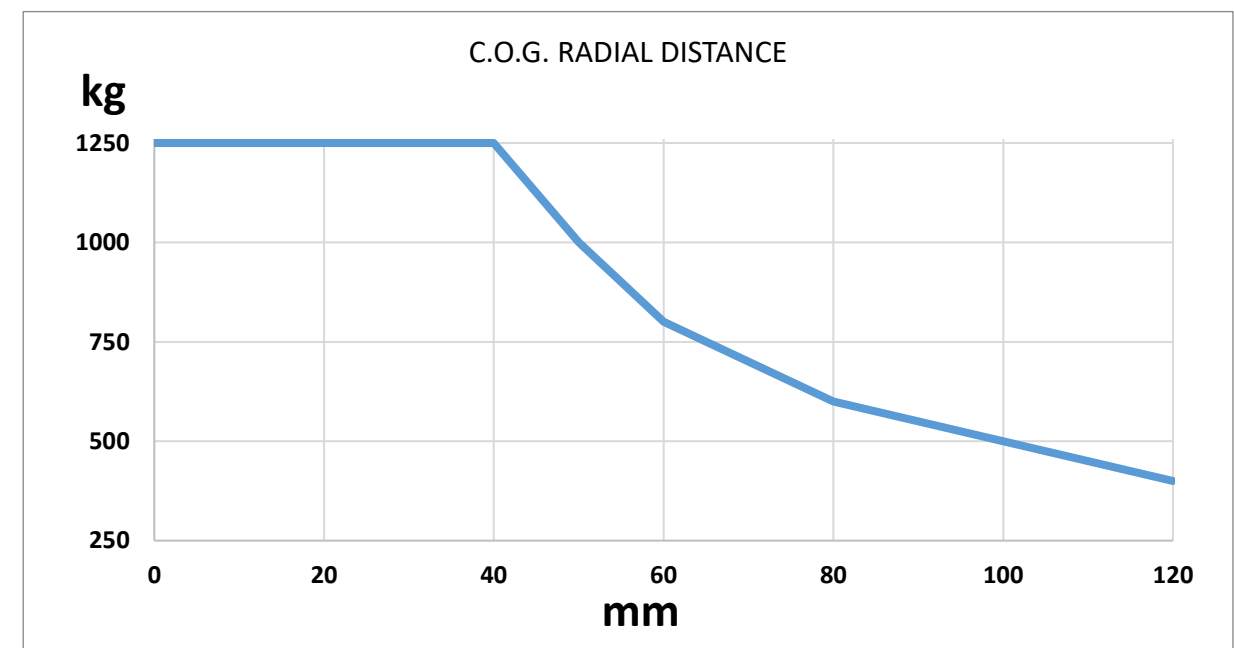
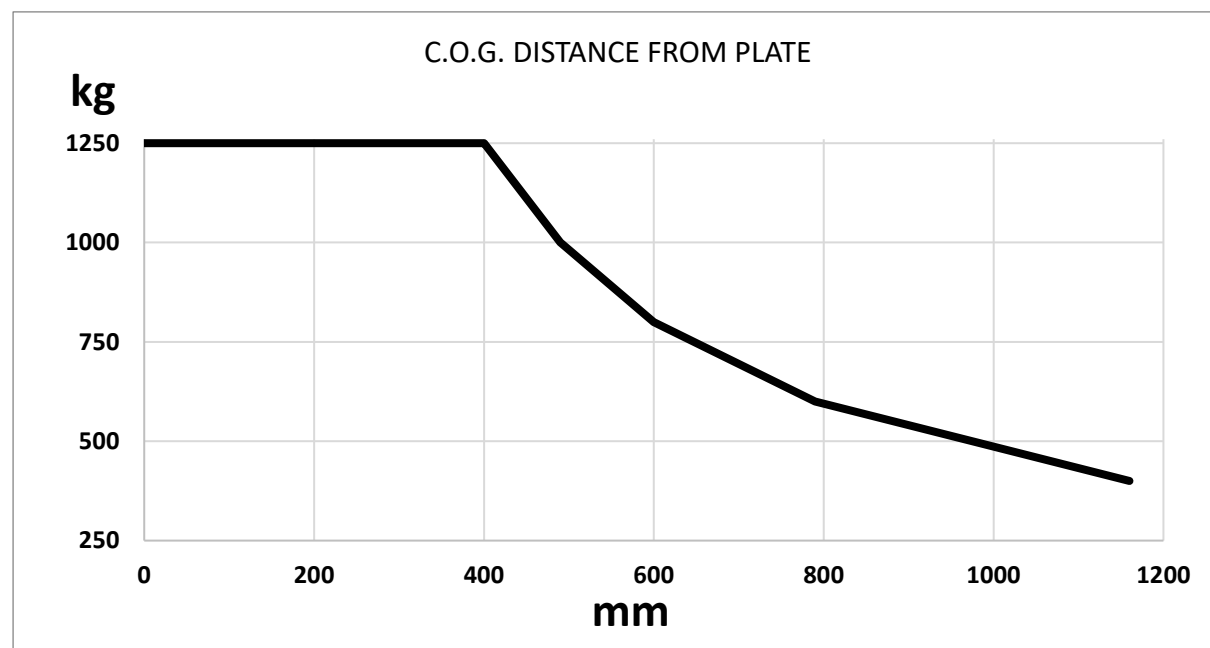



LOADING DIAGRAM RL 2000

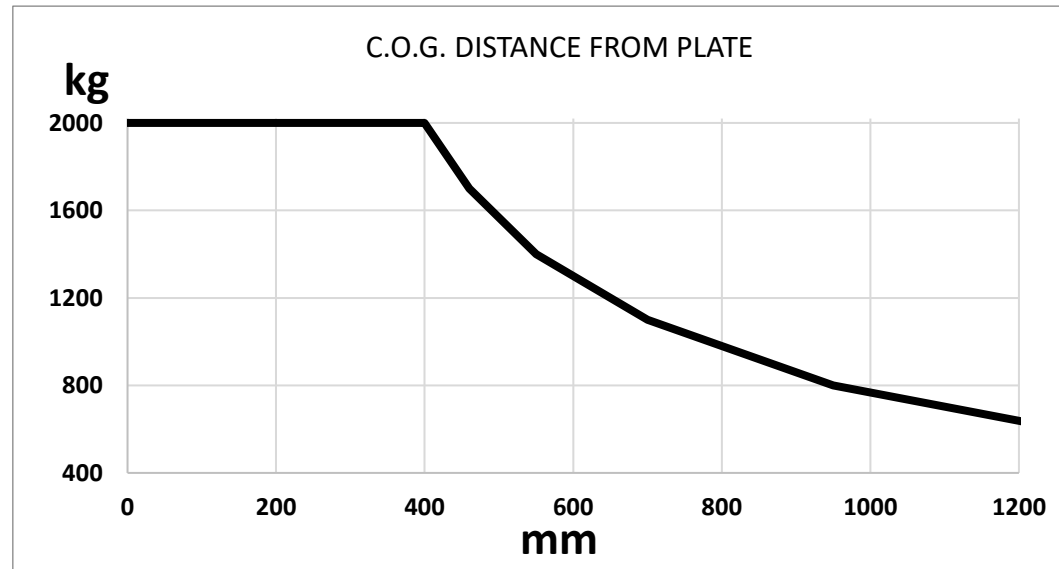

LOADING DIAGRAM RL 2000 - EXTRA INCLINATION 140°

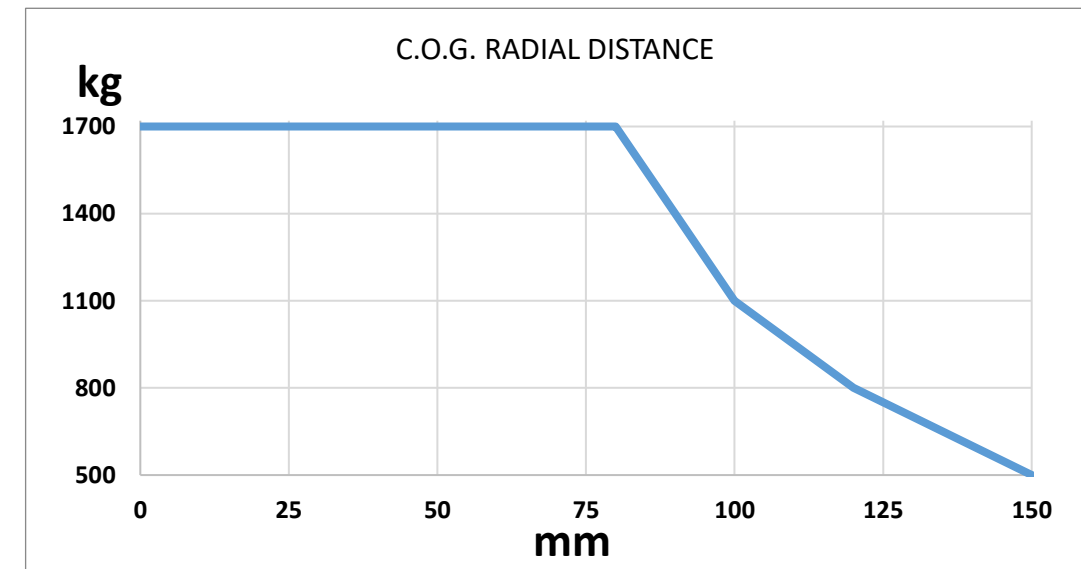
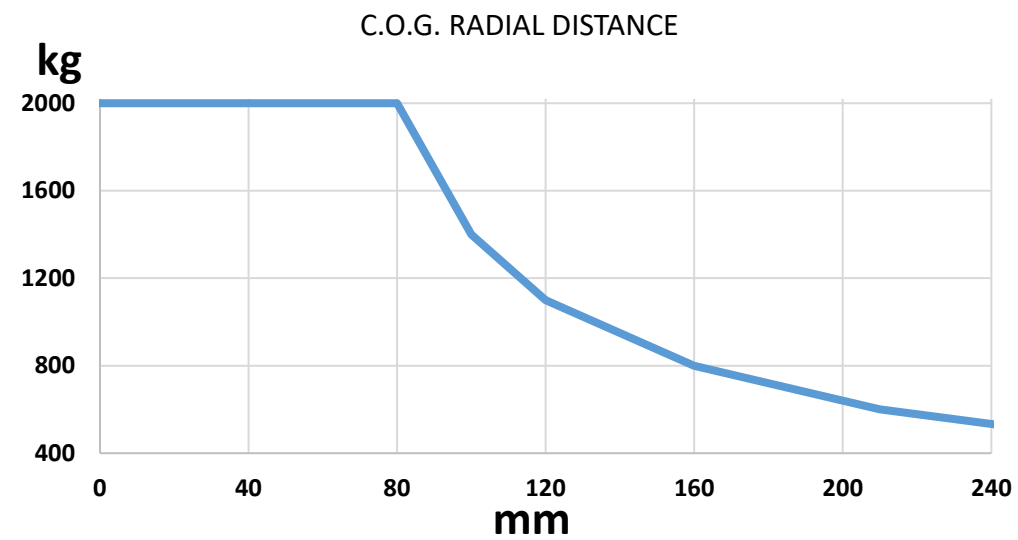
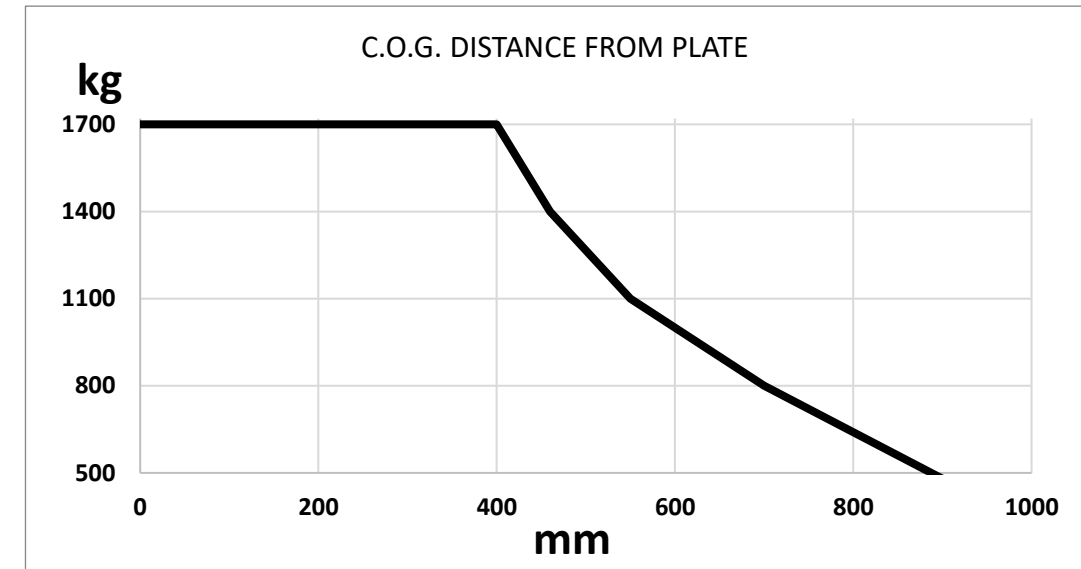

**LOADING DIAGRAM RL 3000**

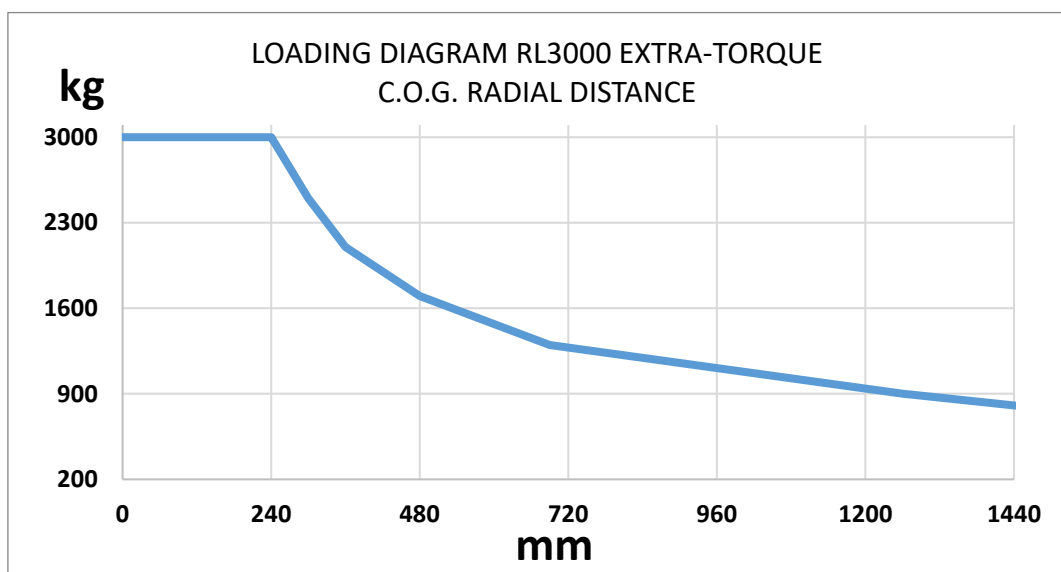
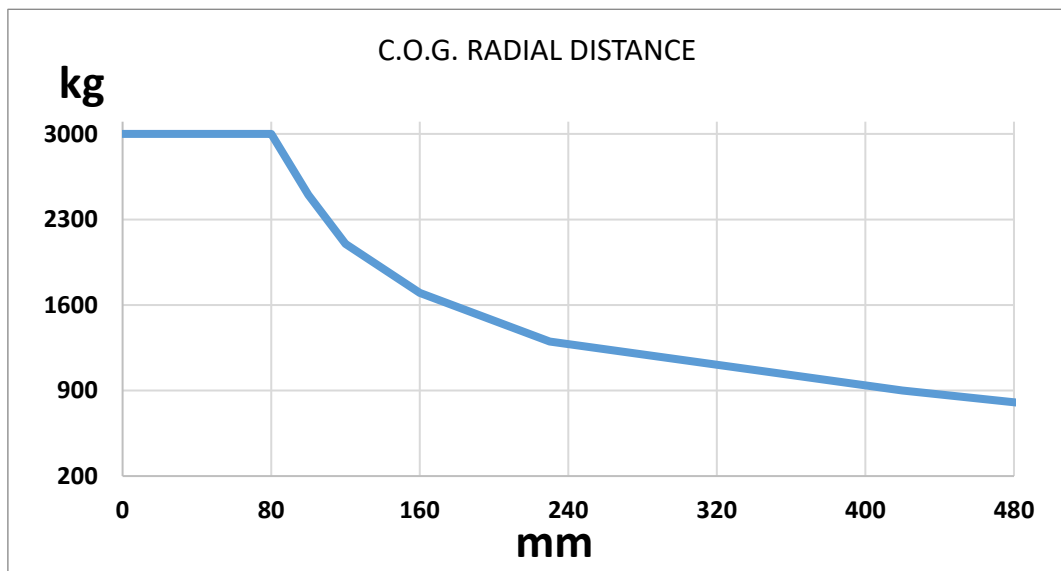
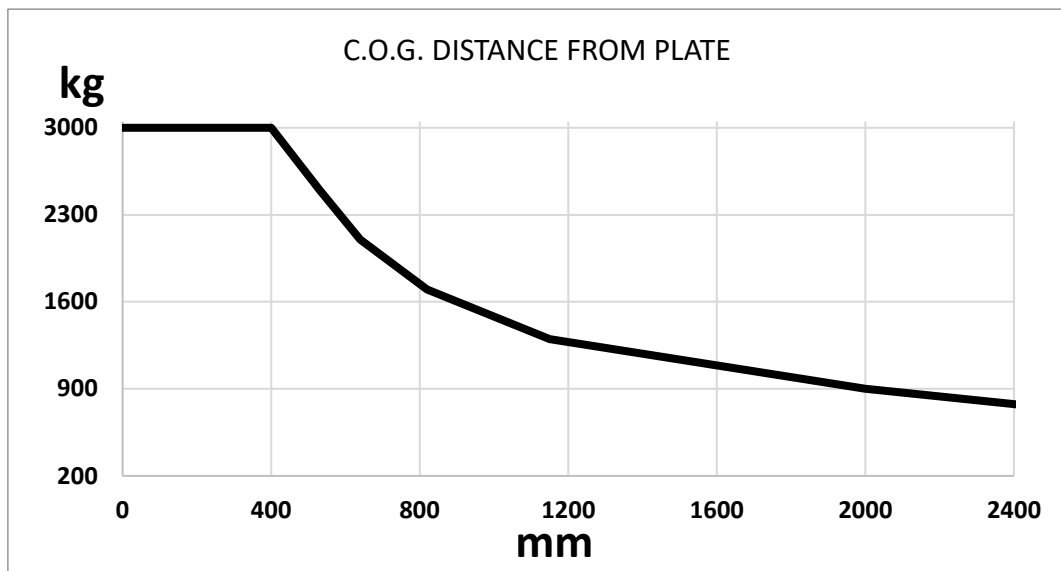

**LOADING DIAGRAM RL 3000 - EXTRA INCLINATION 140°**

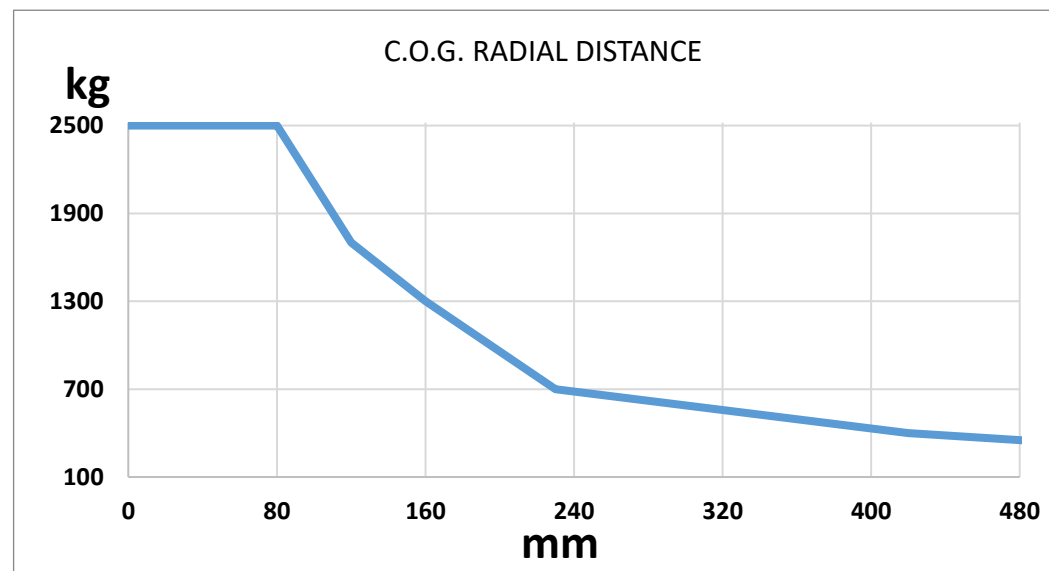
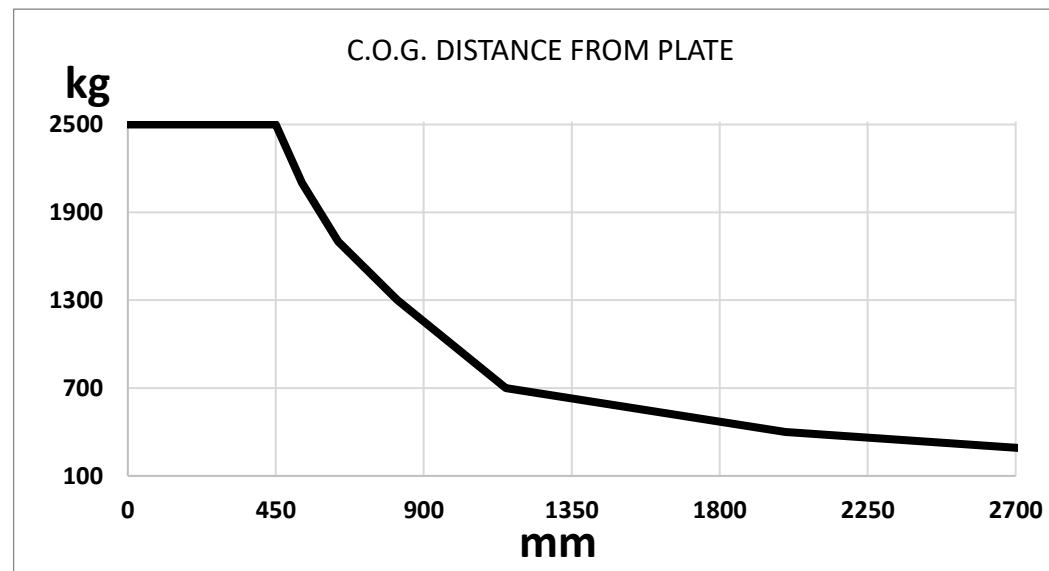



**LOADING DIAGRAM RL 4500**

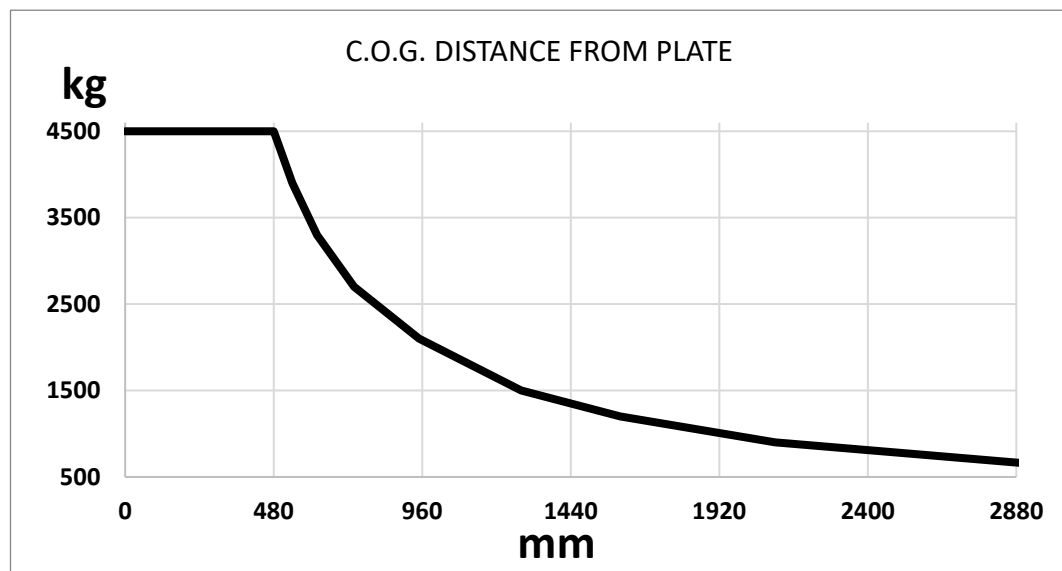

**LOADING DIAGRAM RL 4500 – EXTRA INCLINATION 140°**

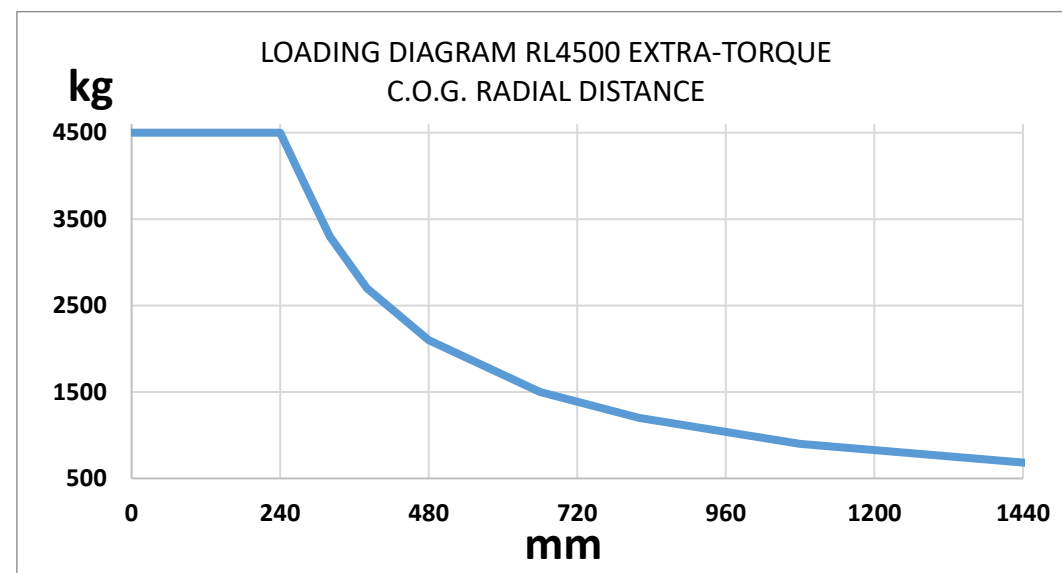
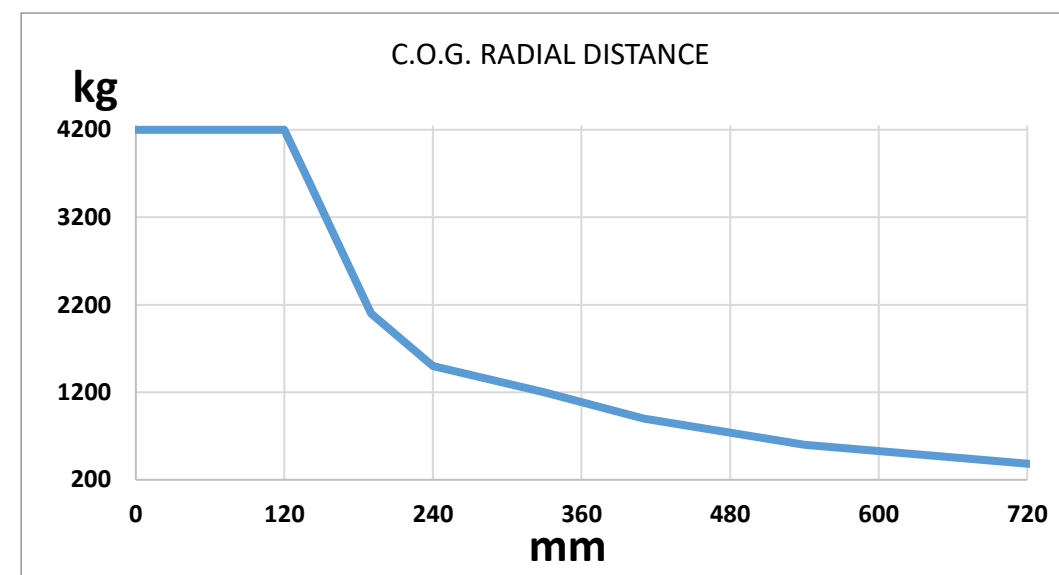
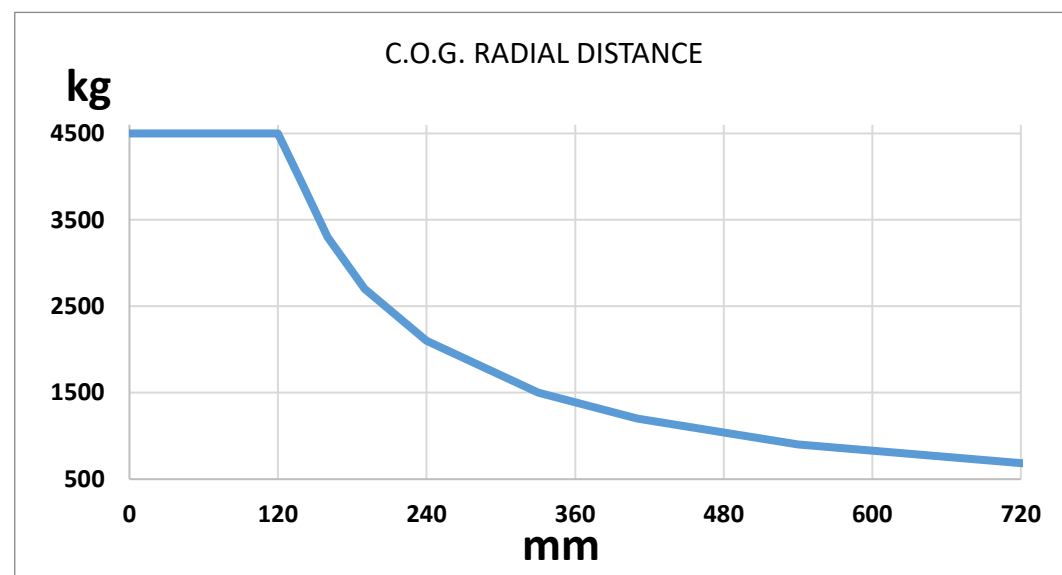
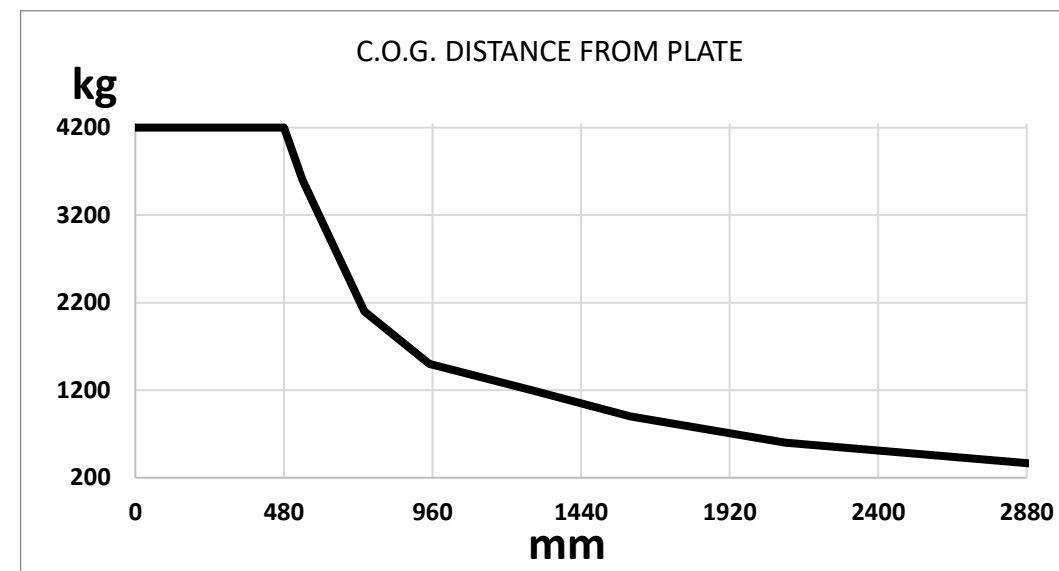

**LOADING DIAGRAM RL 6500**

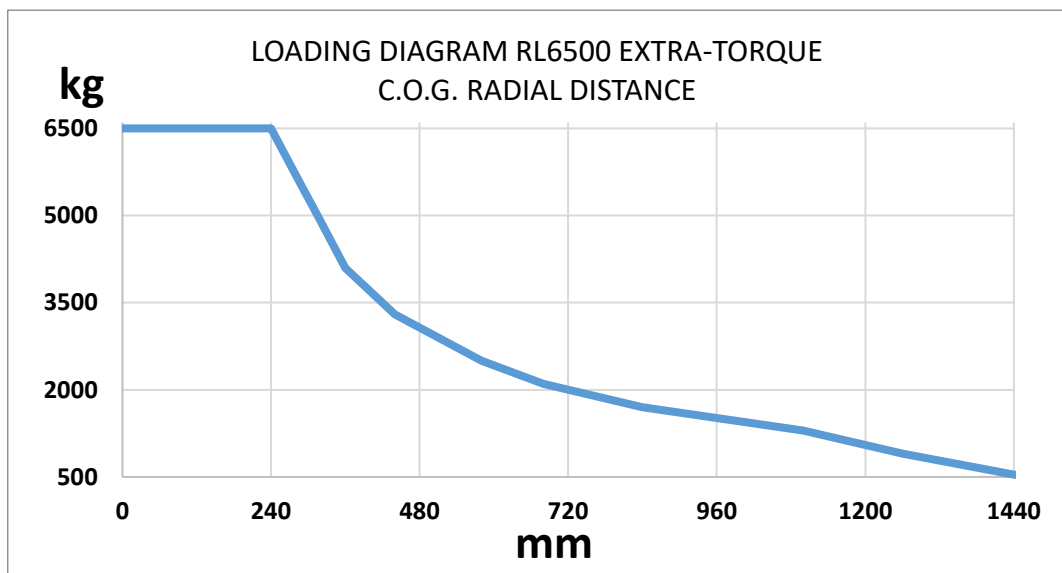
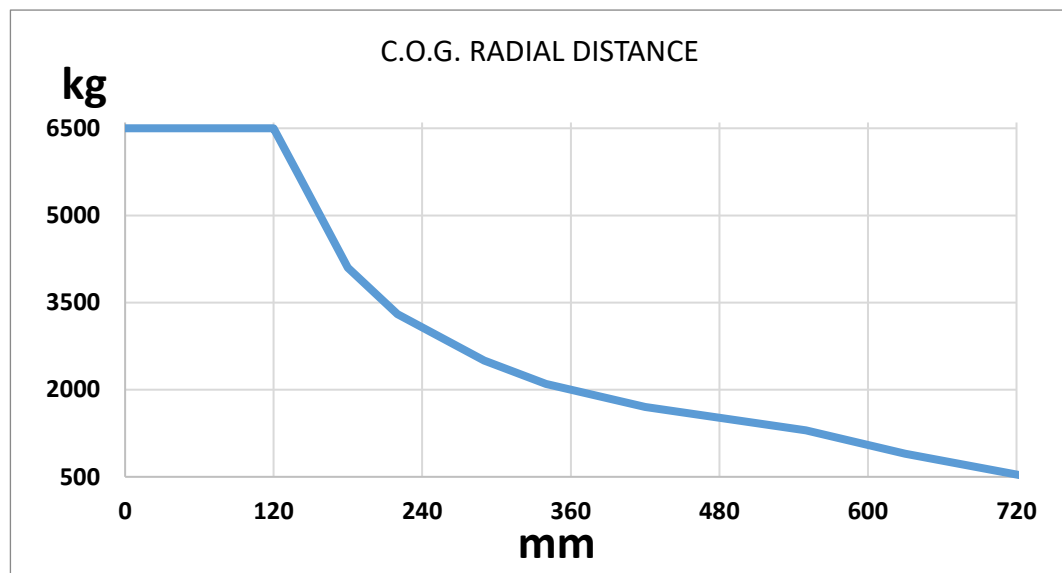
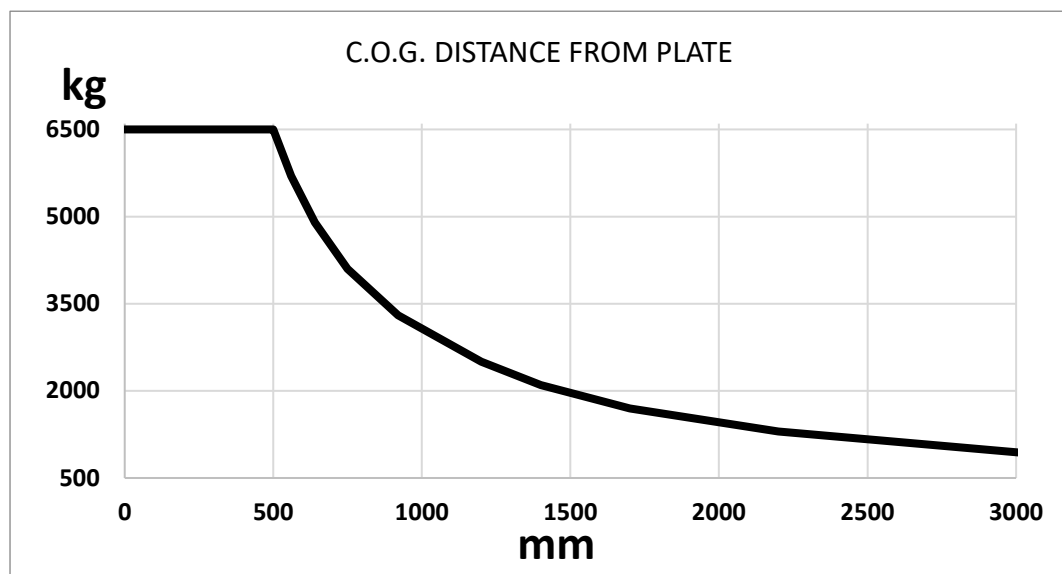

**LOADING DIAGRAM RL 8500**

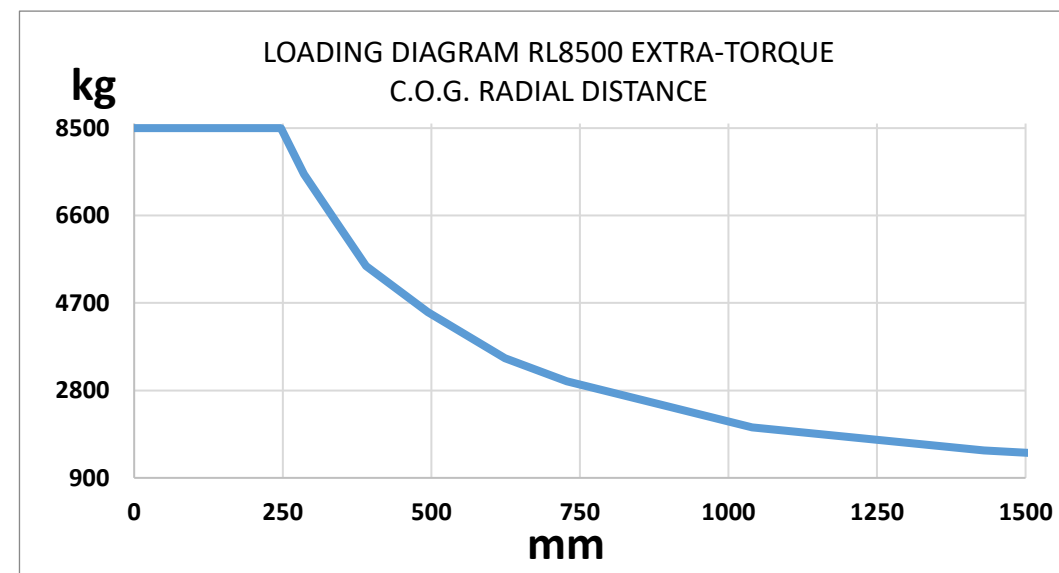
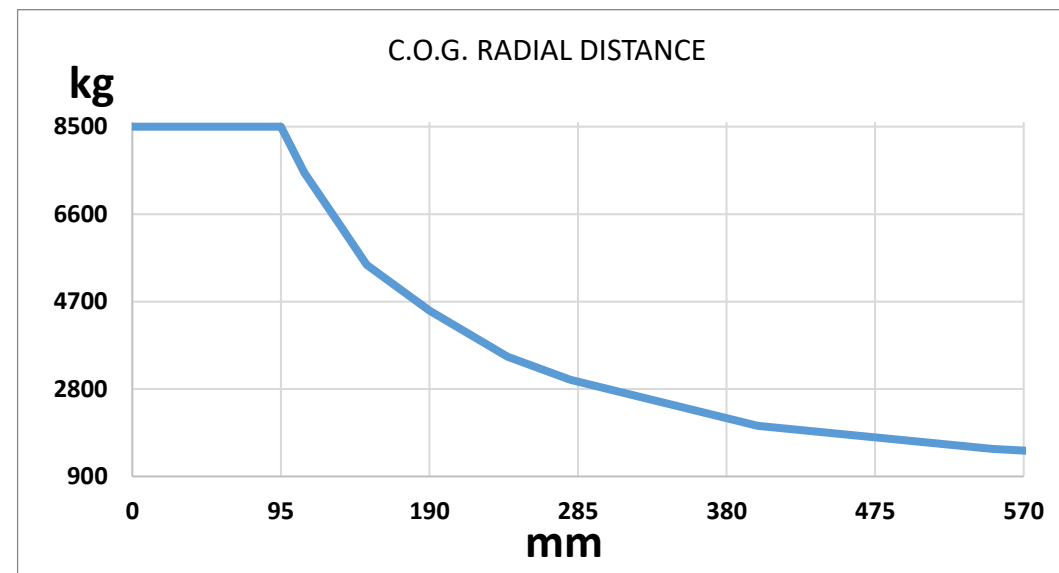
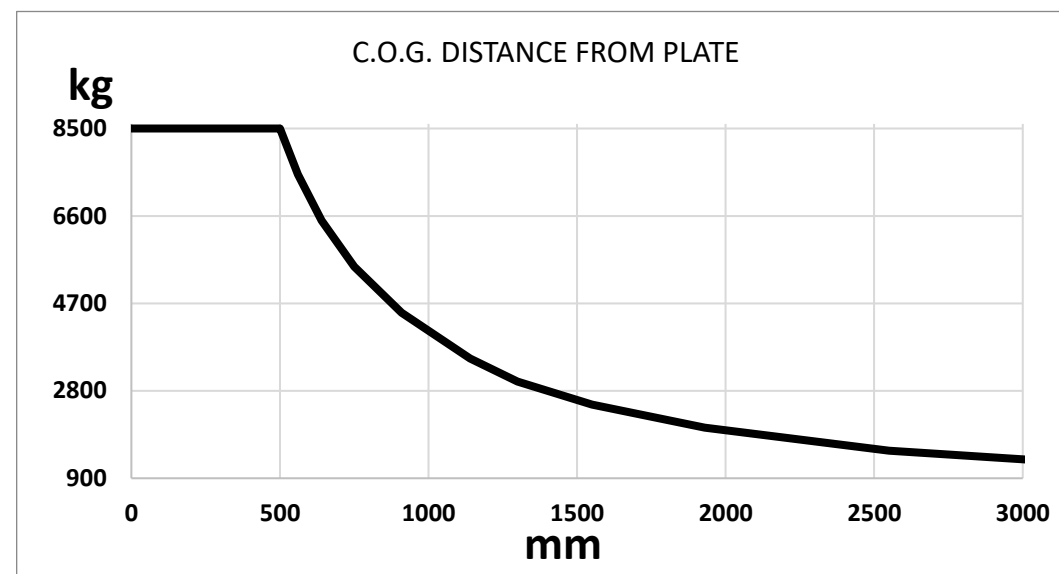

**LOADING DIAGRAM RL 11000**

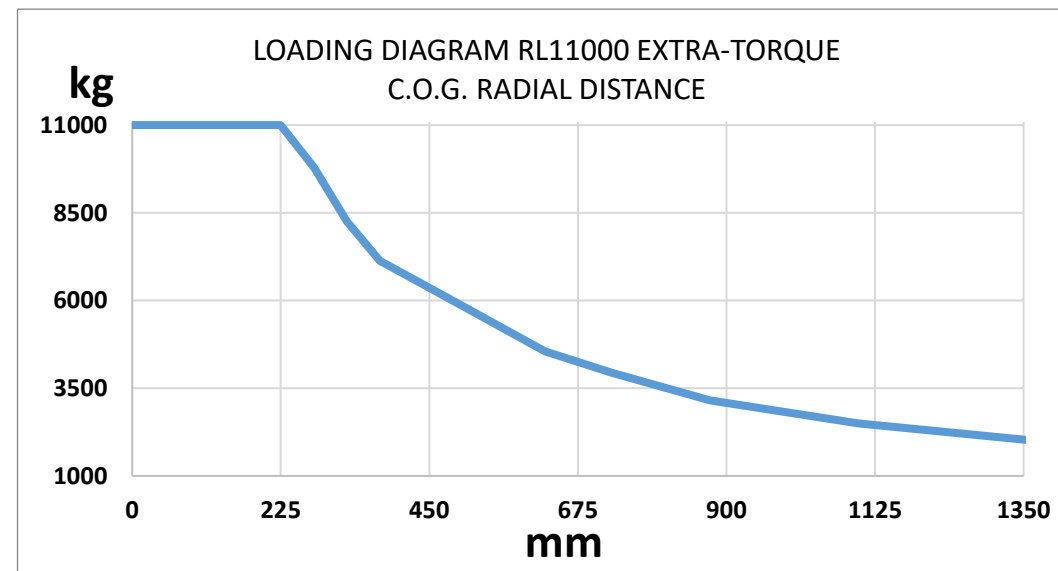
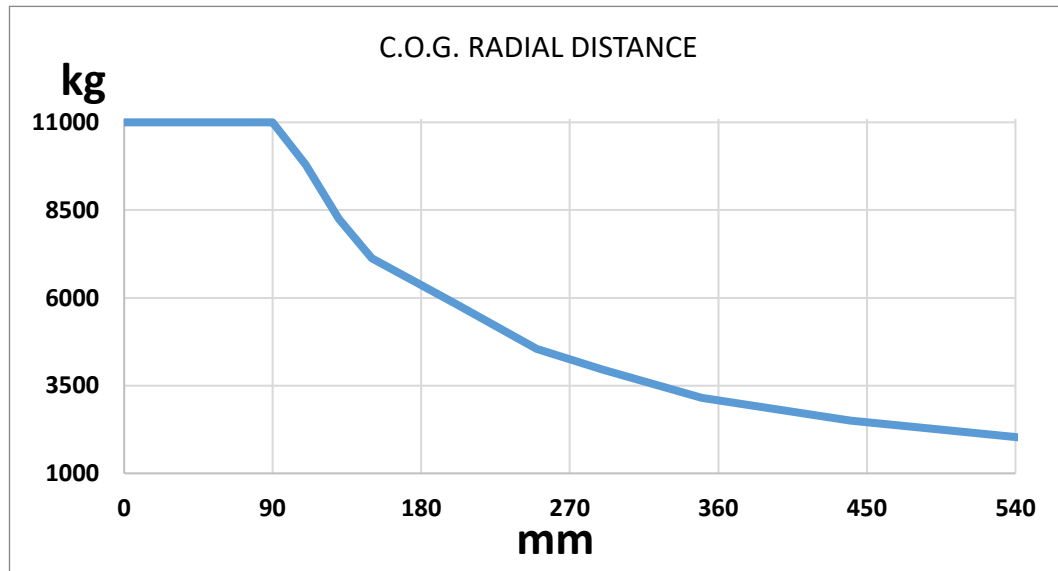
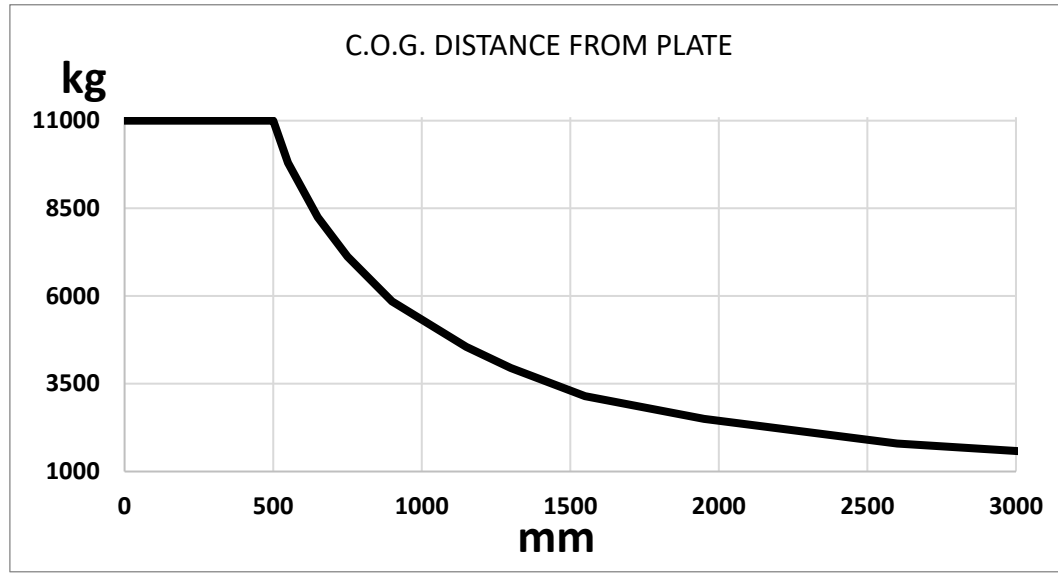

**LOADING DIAGRAM RL 13000**

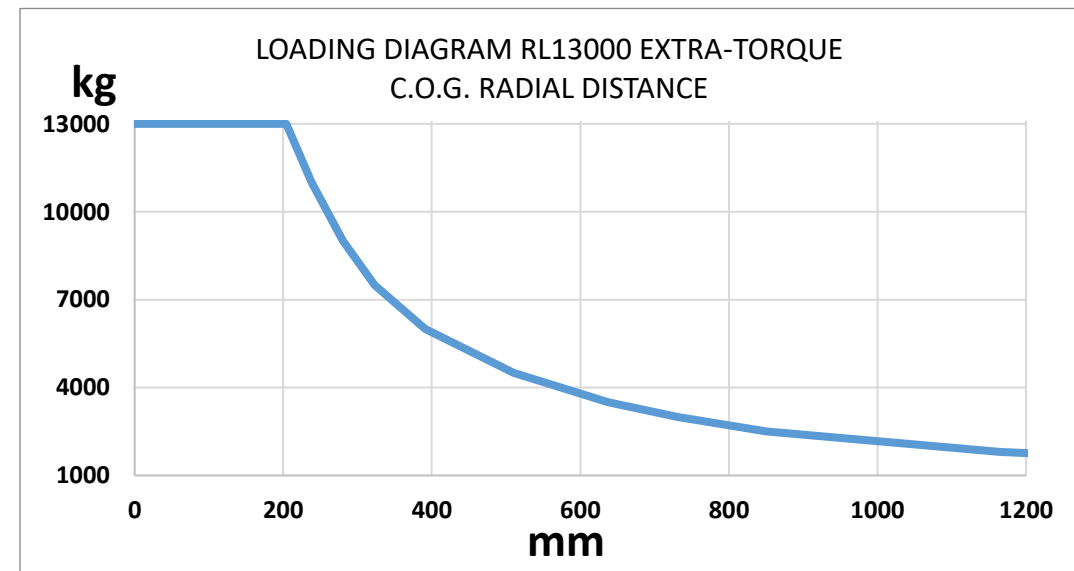
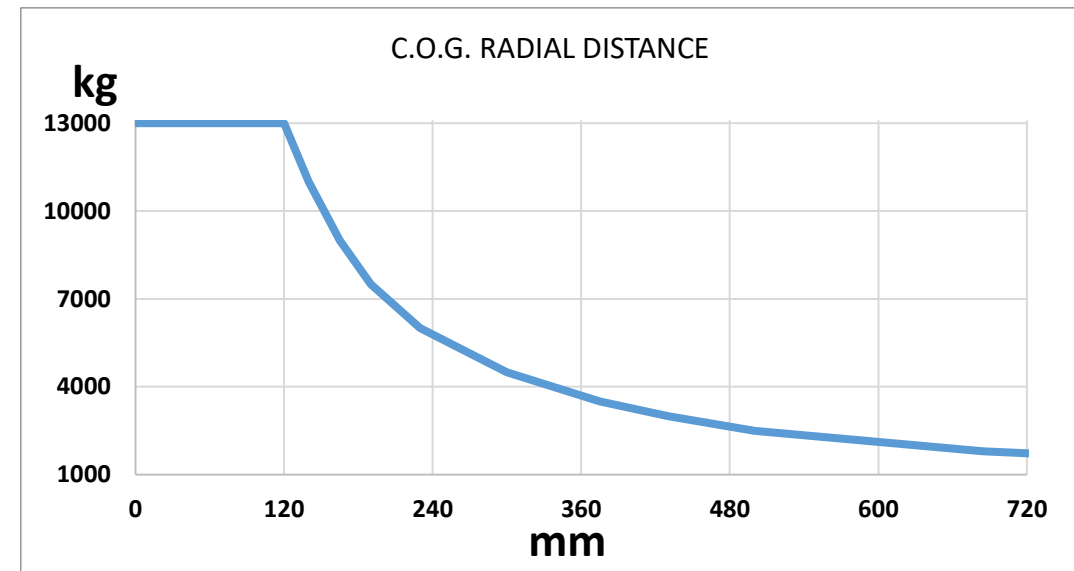
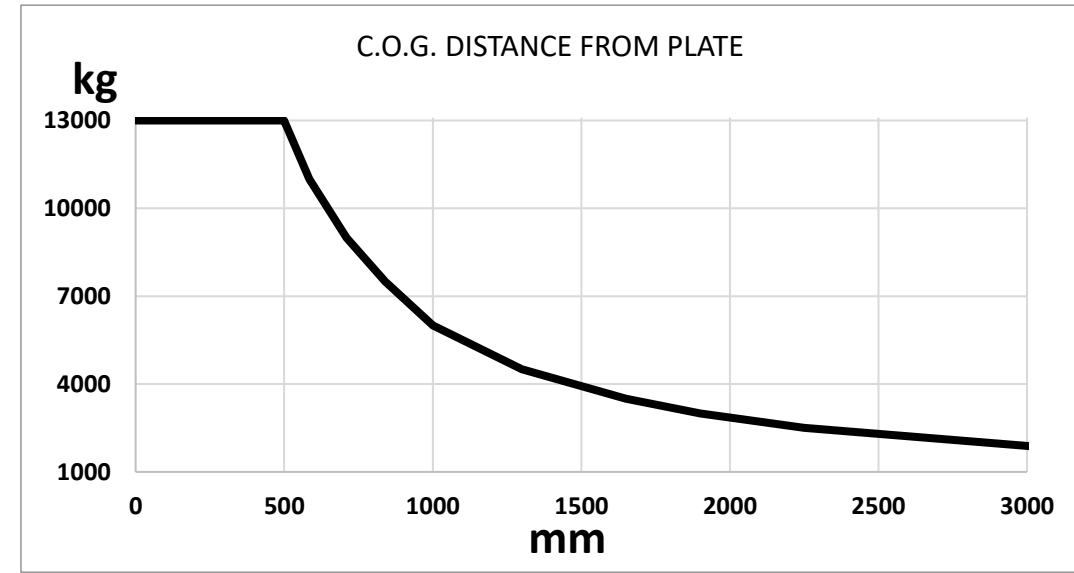

Every information can be modified by Sideros Machinery without prior notice.